

## Overview of Testing Results for Lead in Drinking Water and Corrective Actions for Naval Air Station (NAS) Oceana Midway Manor School-Age Child/Youth Center

The Navy is committed to maintaining safe drinking water on its installations. City of Virginia Beach water supplied to the Navy's water distribution system is regularly tested in compliance with the Safe Drinking Water Act. Exposure to lead is one particular concern because it is a toxic metal that has a range of adverse health effects, including slowed physical and mental development and poor classroom performance in young children. Lead in drinking water may come from the existing plumbing inside buildings, including fittings, solder, water coolers, or water faucets.

The safety and wellness of youth at installation care facilities is one of the top priorities. To reduce children's potential exposure to lead, Navy policy requires that we test the lead content of drinking water in priority areas such as youth centers, child development homes, and child development centers every five years.

In September 2024, Navy environmental personnel conducted lead testing for drinking water at the Midway Manor School-Age Child/Youth Center in accordance with Navy and United States Environmental Protection Agency (EPA) guidelines. Water samples were sent to James R. Reed & Associates, a state-certified laboratory, for analysis.

At Midway Manor, water from outlets used for drinking, cooking, and washing was tested. Out of 8 samples, all drinking water tested less than the 10 parts per billion (ppb) screening level for lead, which is a level designated by the EPA to guide whether additional action is necessary.

A summary of all test results is included for your information in the following enclosures:

- **Enclosure 1:** Summary of results
  - **Table 1 Summary of Results** summarizes the data by category of use. The table provides a description of each sampling location using four columns; *Category*, *Outlet No.*, *Sample Identification*, and *Outlet Description*. The *Category* column contains information about whether the outlet is used for drinking water (water fountain), cooking (food preparation), or washing (primarily handwashing). The *Outlet No.* is the inventory number for the outlets at the facility. The *Sample Identification* column is the unique identification used to label each sample bottle. The *Outlet Description* column contains additional information to describe the outlet sampled under each category. The next set of columns in **Table 1** provides *Initial Sampling Results*. EPA sampling protocol requires water to not be used from 8 to 18 hours prior to first draw sampling, to the extent practicable. Therefore, the *Initial Sampling Results* were from first draw samples collected in the early morning.
  - **Table 2 Summary of Statistics** summarizes all data collected at the building during this event.
- **Enclosure 2:** Floor plan of NAS Oceana Midway Manor School-Age Child/Youth Center and a summary of the outlets tested.

Enclosure 1  
Priority Areas Lead Testing and Corrective Actions  
NAS Oceana, Midway Manor, SAC/Youth Center  
4200 Yorktown Boulevard, Virginia Beach, Virginia

Table 1. Summary of Results

SAMPLING LOCATION DESCRIPTION				INITIAL SAMPLING RESULTS			RE-SAMPLING RESULTS			CORRECTIVE ACTIONS	POST REMEDIATION SAMPLING RESULTS	
				First Draw (ppb)	Retest required?	Date Fixture Secured	Recommended Level = 10 parts per billion (ppb)		First Draw (ppb)		Follow up Flush - Collected 30 seconds after First Draw Sampling (ppb)	Recommended Level = 10 ppb
Water Fountain 15 min. Follow up Flush Sample - Collected day before First Draw Sampling (ppb)		Description	First Draw (ppb)				Follow up Flush - Collected 30 seconds after First Draw Sampling (ppb)					
CATEGORY Water Intended For:	SAMPLE IDENTIFICATION	OUTLET NO.	Outlet Description									
				9/27/2024								
				10/7/2024								
DRINKING	OC-4200-HALL-WFC-FD	2	Hallway water fountain (cooler)	non-detect	No	N/A	N/A	N/A	N/A	N/A	N/A	N/A
DRINKING	OC-4200-K-KSPRAY	13	Sprayer in kitchen sink used for filling water jugs or bottles	non-detect	No	N/A	N/A	N/A	N/A	N/A	N/A	N/A
COOKING	OC-4200-K-K-FD	8	Kitchen sink for dishwashing and food preparation	non-detect	No	N/A	N/A	N/A	N/A	N/A	N/A	N/A
WASHING	OC-4200-RM2-HHW-FD	1	Activity Room 2 high hand washing faucet	non-detect	No	N/A	N/A	N/A	N/A	N/A	N/A	N/A
WASHING	OC-4200-BATHW-HHWA-FD	3	Women's Restroom high hand washing faucet A	non-detect	No	N/A	N/A	N/A	N/A	N/A	N/A	N/A
WASHING	OC-4200-BATHW-HHWB-FD	4	Women's Restroom high hand washing faucet B	non-detect	No	N/A	N/A	N/A	N/A	N/A	N/A	N/A
WASHING	OC-4200-BATHM-HHWA-FD	6	Men's Restroom high hand washing faucet A	non-detect	No	N/A	N/A	N/A	N/A	N/A	N/A	N/A
WASHING	OC-4200-BATHM-HHWB-FD	7	Men's Restroom high hand washing faucet B	non-detect	No	N/A	N/A	N/A	N/A	N/A	N/A	N/A

Table 2. Summary Statistics

CATEGORY	INITIAL SAMPLING RESULTS		RE-SAMPLING RESULTS			POST REMEDIATION RESULTS
	First Draw	Recommended Level = 10 parts per billion (ppb)				
		Water Fountain Follow up Flush Sample - Collected day before First Draw Sampling	First Draw	Follow up Flush - Collected 30 seconds after First Draw Sampling	First Draw	
Total Drinking	2	0	0	0	0	
Total Drinking > 10 ppb	0	0	0	0	0	
Total Cooking	1	0	0	0	0	
Total Cooking > 10 ppb	0	0	0	0	0	
Total Washing/Brushing	5	0	0	0	0	
Total Washing/Brushing > 10 ppb	0	0	0	0	0	
Total Samples	8	0	0	0	0	
Total Samples > 10 ppb	0	0	0	0	0	

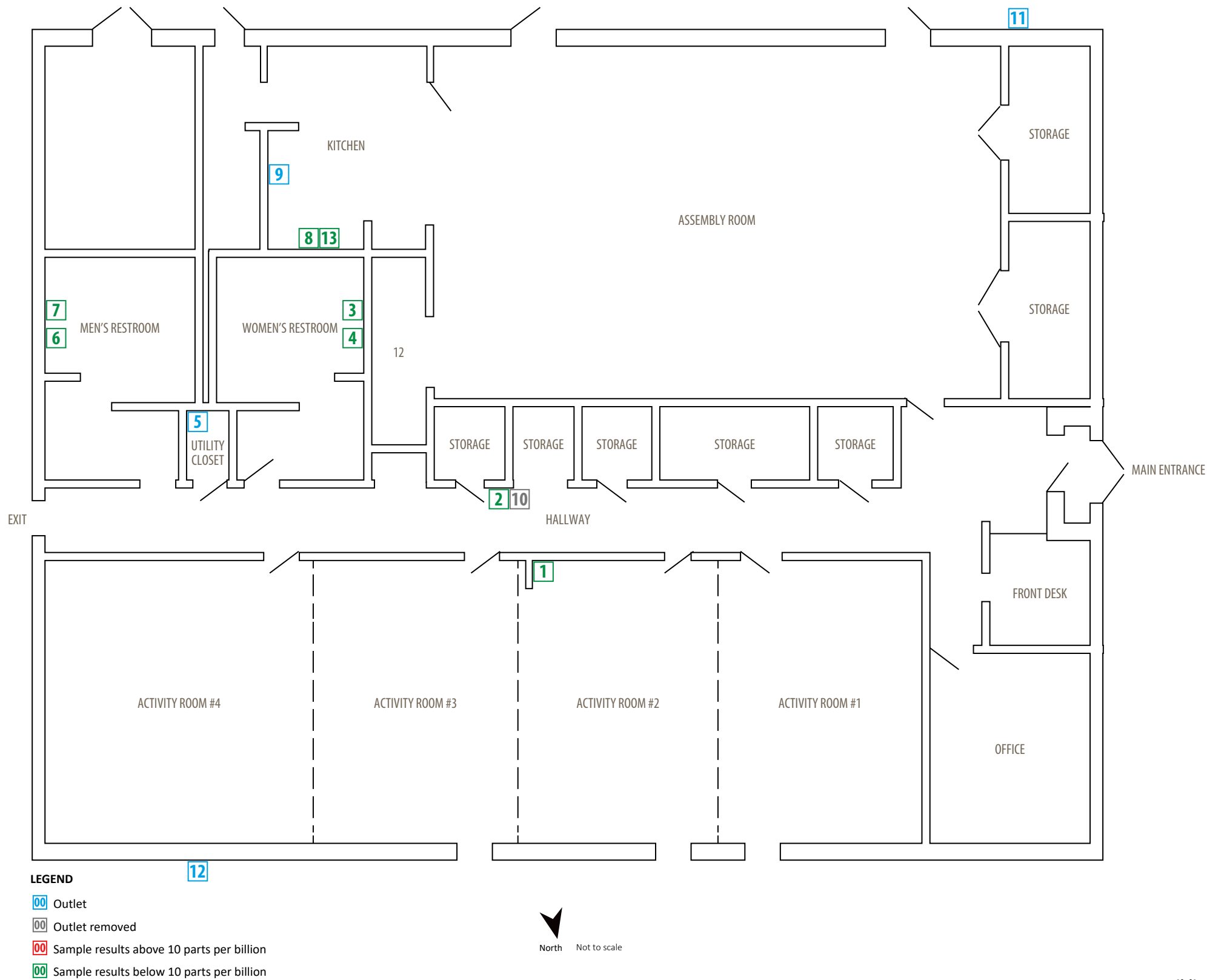

**Building 4200 – Floor Plan**  
NAS Oceana Midway Manor  
Virginia Beach, Virginia



Outlet No.	Type of Fixture	Location Description	Exceeded?
1	High hand washing faucet	Activity Room 2	No
2	Water fountain (cooler)	Hallway	No
3	High hand washing faucet	Women's Restroom	No
4	High hand washing faucet	Women's Restroom	No
5	Utility sink	Utility Closet	Not sampled – not used for drinking
6	High hand washing faucet	Men's Restroom	No
7	High hand washing faucet	Men's Restroom	No
8	Kitchen sink faucet for dishwashing and food preparation	Kitchen	No
9	Ice maker	Kitchen	Not sampled – not used for drinking
10	Bottle spigot attached to water fountain (cooler)	Hallway	Outlet removed
11	Hose bib	Southwest side of Building 4200	Not sampled – not used for drinking
12	Hose bib	Northeast side of Building 4200	Not sampled – not used for drinking
13	Sprayer in kitchen sink used for filling water jugs or bottles	Kitchen	No